

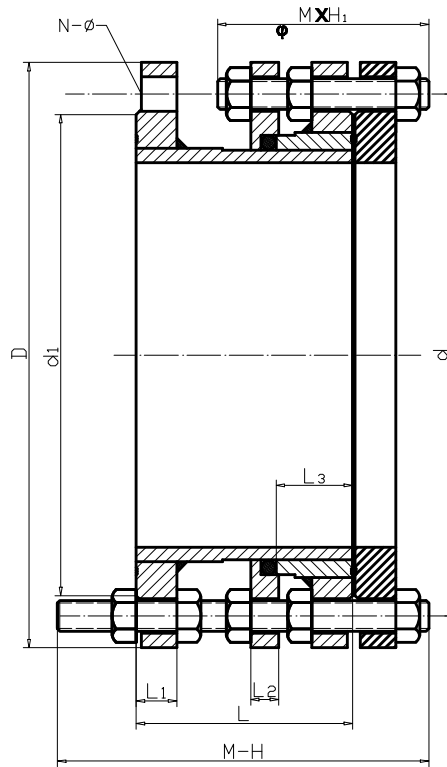

Expansion Joint  
(1.0Mpa) (DN80-2000)



Note: Expansion adjustment quantity is  
DN50-250=40mm,  
300-700=50mm,  
800-1200=60mm,  
1400-2000=70mm

Dimensions(mm)

DN	L	L <sub>1</sub>	L <sub>2</sub>	L <sub>3</sub>	D	d	d <sub>1</sub>	N-φ	M-H	M-H <sub>1</sub>
80	160	16	16	70	200	160	138	8-14	12-320	12-180
100	170	18	16	80	220	180	158	8-18	16-320	16-180
125	170	20	16	80	250	210	184	8-18	16-340	16-200
150	180	20	16	80	285	240	212	8-22	20-350	20-210
200	180	20	16	80	340	295	268	8-22	20-350	20-210
250	180	20	16	80	395	350	320	12-22	20-350	20-210
300	200	22	22	80	445	400	370	12-22	20-380	20-220
350	200	22	22	80	505	460	430	16-22	20-380	20-220
400	200	24	24	80	565	515	482	16-26	24-400	24-240
450	200	26	24	80	615	565	532	20-26	24-400	24-240
500	200	28	24	100	670	620	585	20-26	24-400	24-240
600	210	30	28	100	780	725	685	20-30	27-430	27-260
700	210	30	28	100	895	840	800	24-30	27-430	27-260
800	310	32	28	110	1015	950	905	24-33	30-580	30-300
900	310	32	30	110	1115	1050	1005	28-33	30-580	30-300
1000	310	34	32	110	1230	1160	1110	28-36	33-600	33-320
1200	320	38	32	120	1455	1380	1330	32-39	36-600	36-340
1400	320	42	34	130	1675	1590	1535	36-42	39-600	39-340
1600	360	46	34	140	1915	1820	1760	40-48	45-680	45-365
1800	360	50	36	140	2115	2020	1960	44-48	45-680	45-365
2000	380	54	36	150	2325	2230	2170	48-48	45-710	45-400